

GROSS LOAD CAPACITY WHEN USED AS A WEIGHT CARRYING HITCH: 5,000 LBS. TRAILER WEIGHT & 500 LBS. TONGUE WEIGHT.
*****DO NOT EXCEED VEHICLE MANUFACTURER'S RECOMMENDED TOWING CAPACITY.*****

1	2	3/4 - 10 x 3 HEX	HEX HEAD BOLT-NC
2	2	3/4-10	HEX FLANGE NUT
3	2	1/2-13 x 2"	HEX BOLT
4	2	HFN 1213	HEX FLANGE NUT
5	2	CM-SP15	.250 x 1.50 x 1.50" SPACER

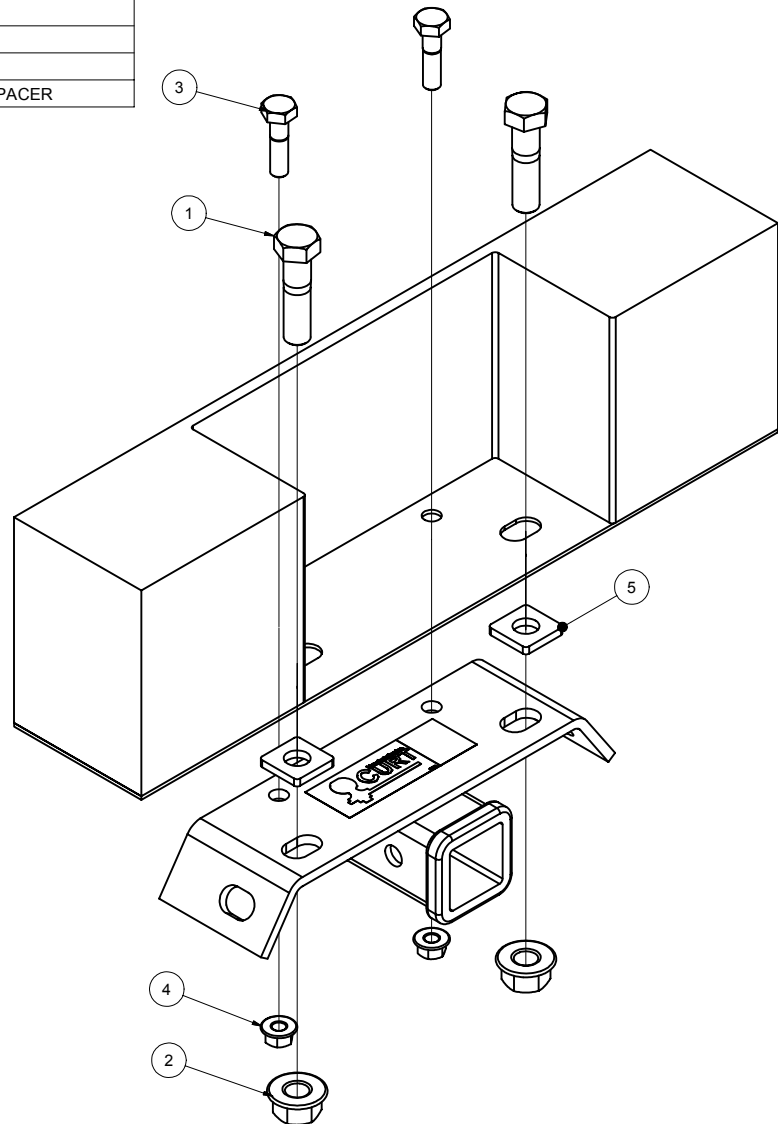

HITCH WEIGHT: 9 LBS.

INSTALL TIME: 10 MINUTES

INSTALL NOTES:

INSTALLATION STEPS

- 1) Position CURT Hitch to the underside of the original vehicle step plate.
- 2) Use existing holes if present. If existing holes can not be used, mark and drill holes for two 3/4" bolts and two 1/2" bolts.
- 3) Assemble using (A) 3/4" X 3 bolts and flange nuts (a) 1/2" X 2 bolts and flange nuts.
- 4) Spacers for 3/4" bolts (B) are provided. Use these spacers only if there is a welded tab on the underside of your bumper. It is very important to TIGHTEN NUTS SECURELY!

PERIODICALLY CHECK THIS RECEIVER HITCH TO ENSURE THAT ALL FASTENERS ARE TIGHT AND THAT ALL STRUCTURAL COMPONENTS ARE SOUND.